



1221 COLUMBIA DR

PROPERTY OVERVIEW

1221 Columbia Dr is 1.333 acres of land, improved with a 4,929 SF brick building formerly occupied by Wells Fargo. The Site includes 73 parking spaces and is located adjacent to Avondale Crossing, a 115,000 sf community strip center owned and managed by Selig Enterprises, Inc.



**1221 COLUMBIA DR
DECATUR, GA 30032**



SHIRLEY A. GOUFFON

404.898.9012

sgouffon@seligenterprises.com



KIMBERLY BOARDMAN

404.870.1519

kboardman@seligenterprises.com



SELIG

seligenterprises.com

1221 COLUMBIA DR

1221 COLUMBIA DR
DECATUR, GA 30032

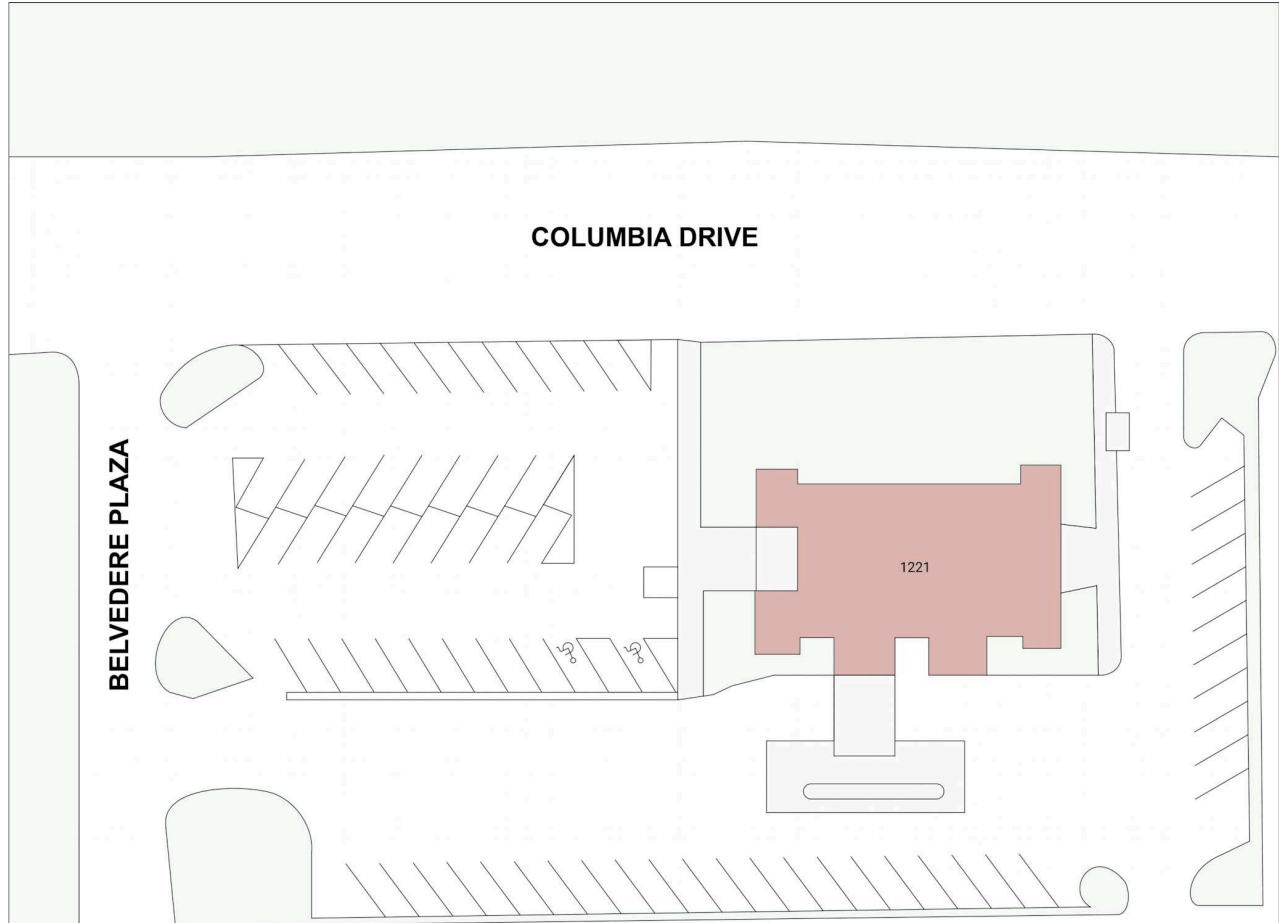

Suite

Tenant

1221

AVAILABLE (4,926 sf)



Shirley A. Gouffon



404.898.9012



sgouffon@seligenterprises.com

1221 COLUMBIA DR

1221 COLUMBIA DR
DECATUR, GA 30032



SUITE 1221

RENTAL RATES

Rental Rate PSF	\$17.00
Ancillary Charges*	\$5.88
*CAM / Taxes / Insurance / Trash (if applicable; charges are approximate)	

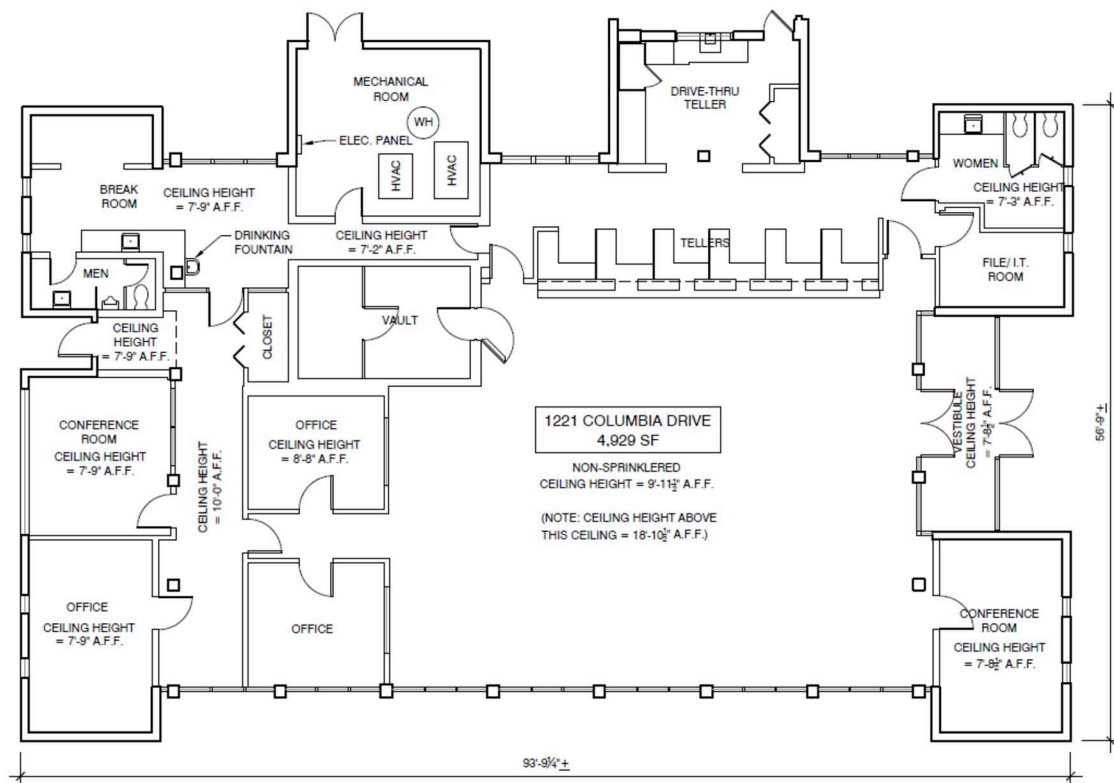

Shirley A. Gouffon



404.898.9012



sgouffon@seligenterprises.com